

REV	DESCRIPTION	DATE	BY
A	NEW DRAWING	11/02/09	JAG

SKT3355

**TOP**

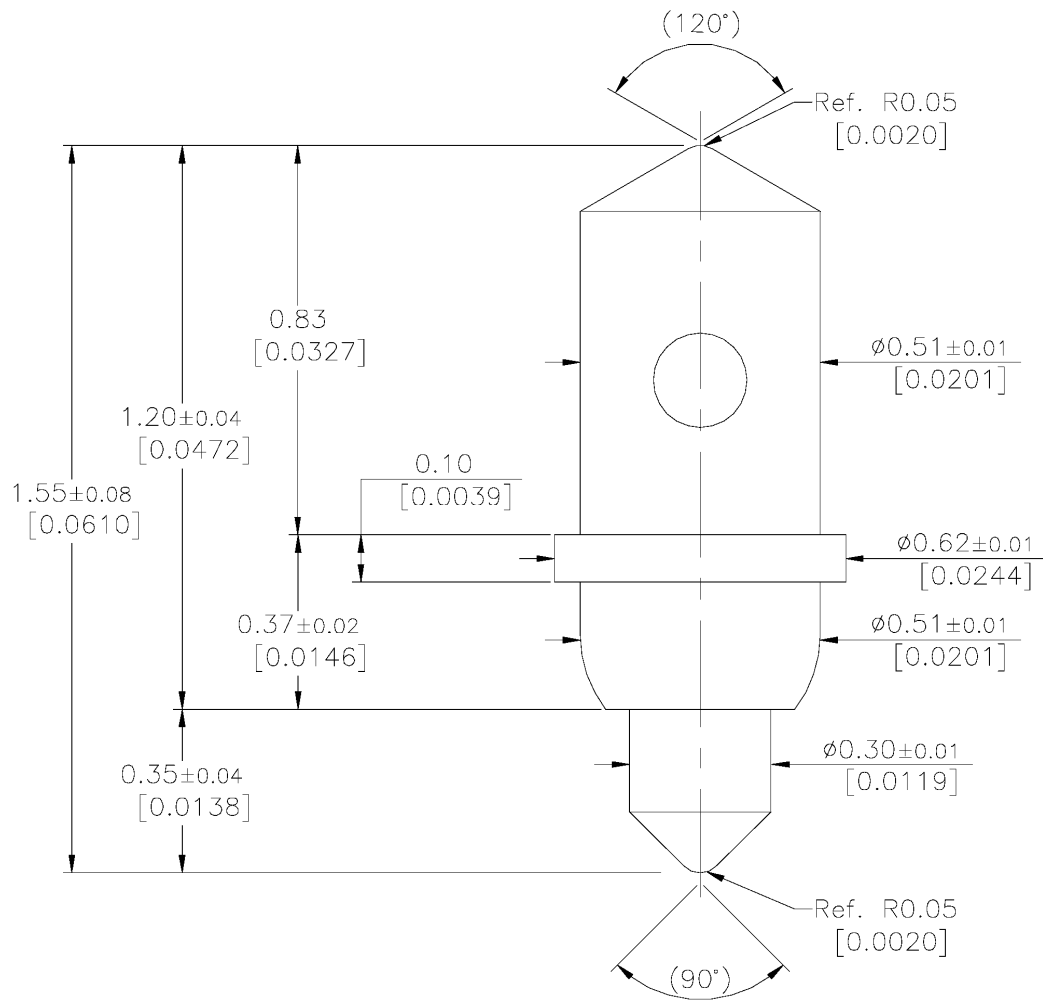

**BOTTOM**

Pointing accuracy :  $\pm 0.05$  mm

Spring force [ $\pm 20\%$ ]

10.5g(0.370oz) at initial travel

20.0g(0.705oz) at 0.23mm(0.0091) recommended travel

24.0g(0.847oz) at 0.31mm(0.0122) full travel

**Material & Finish**

Plunger Hardened Beryllium copper / Gold Plated

Barrel Hardened Beryllium copper / Gold Plated

Spring Music Wire / Gold Plated

**NOTICE:** Must be reflected in a socket design.

When this probe is set in a socket, it is very important to verify the actual working travel due to the difference of 0.08mm between the recommended and full travel. In case the actual working travel is over 0.23mm, the device, spring, plunger, and/or PCB pad will be damaged.

ALL DIMENSIONS ARE IN MILLIMETERS UNLESS OTHERWISE SPECIFIED



**EMULATION TECHNOLOGY, INC.**

VLSI and SMT ADAPTERS and ACCESSORIES

759 FLYNN ROAD  
CAMARILLO, CA 93012

TEL: (805) 383-8480  
FAX: (805) 383-8484

SHEET:  
1 OF 1

DATE:  
11/02/09

REVISION:  
A

**ASSEMBLY DRAWING**

CHECKED:

PREPARED BY:  
J. GELACIO

ITEM:

POGO-PIN-1.55-1

DESCRIPTION:

POGO-PIN-1.55-1

DO NOT SCALE DRAWING

Unit : Millimeter[inch]