

REV	DESCRIPTION	DATE	BY
A	NEW DRAWING	05/09/05	H.N.

SKT2295

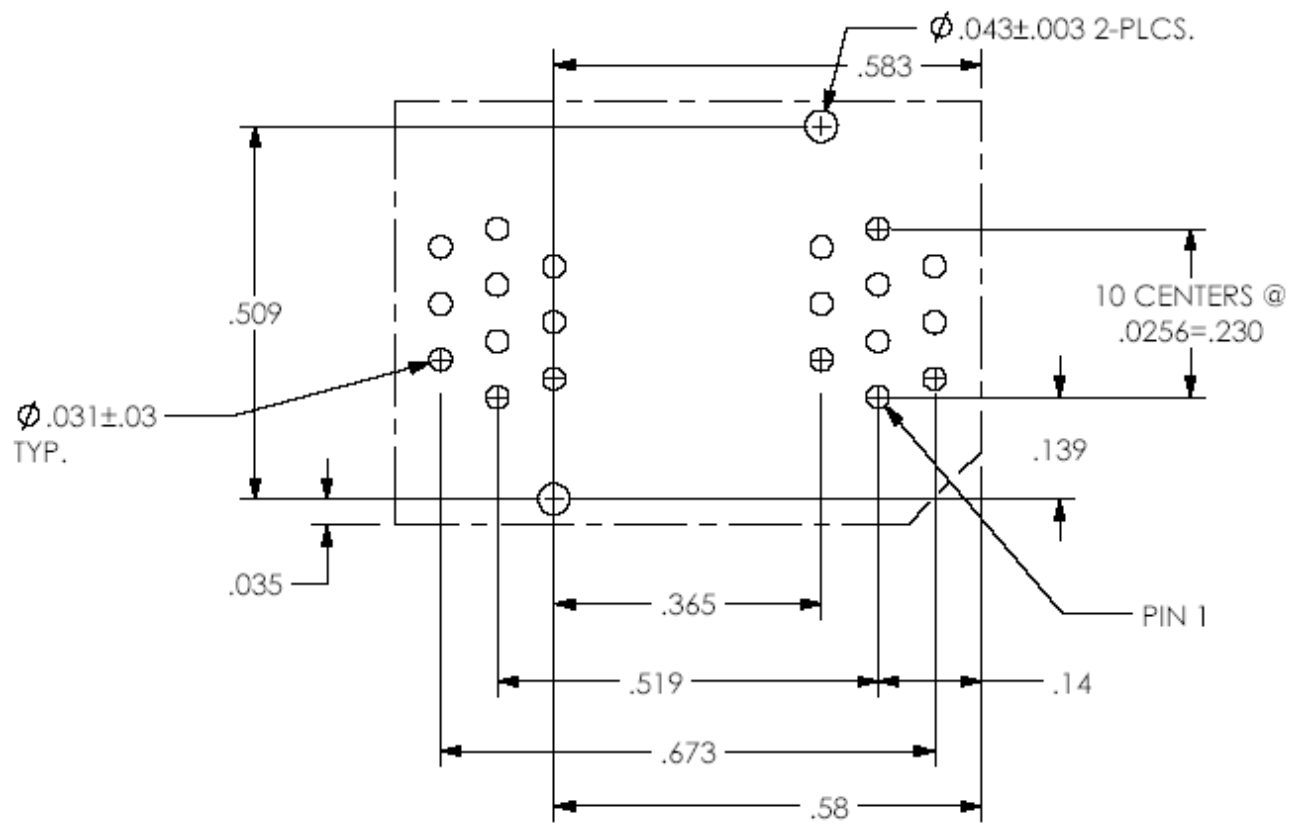
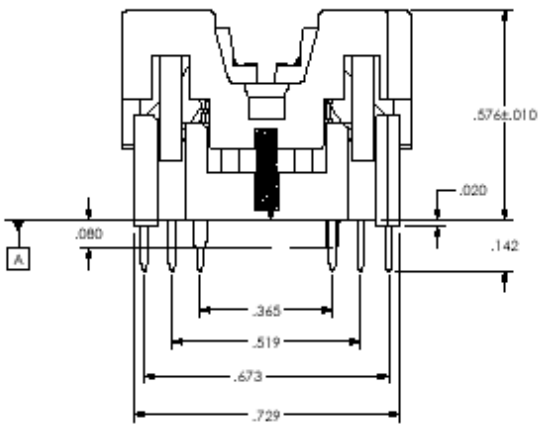
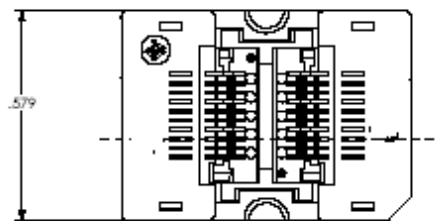

**FOOTPRINT**  
 FOOTPRINT AS VIEWED LOOKING DOWN FROM TOP OF SOCKET.  
 RECOMMENDED HOLE PATTERN

ALL DIMENSIONS ARE IN INCHES UNLESS OTHERWISE SPECIFIED

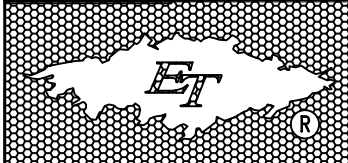

**Emulation Technology, Inc.**  
 — VLSI and SMT ADAPTERS and ACCESSORIES —  
 2344 Walsh Avenue, Bldg.F Santa Clara, Ca 95051  
 TEL:(408)982-0660 FAX:(408)982-0664

PACKAGE SPECIFICATIONS	
PIN COUNT	= 20
LEAD PITCH	= 0.65mm
PACKAGE WIDTH	= 4.40mm
ET PACKAGE CODE	= 20-ST03

SHEET: 1 OF 1	DATE: 05/09/05	REVISION: A	<b>ASSEMBLY DRAWING</b>
CHECKED: Perry Munroe	DRAWN: Huy Nguyen	ITEM: S-TSS0-00-020-B	
Scale N/A	DO NOT SCALE DRAWING	DESCRIPTION: S-TSS-00-020-B	