

| REV | DESCRIPTION        | DATE     | BY   |
|-----|--------------------|----------|------|
| A   | NEW DRAWING        | 6/7/00   | M.D. |
| B   | UPDATED PCB LAYOUT | 7/19/01  | A.F. |
| C   | ADDED DIMENSION    | 06/20/03 | H.N. |
| D   | UPDATED DRAWING    | 12/05/05 | H.N. |

SKT002

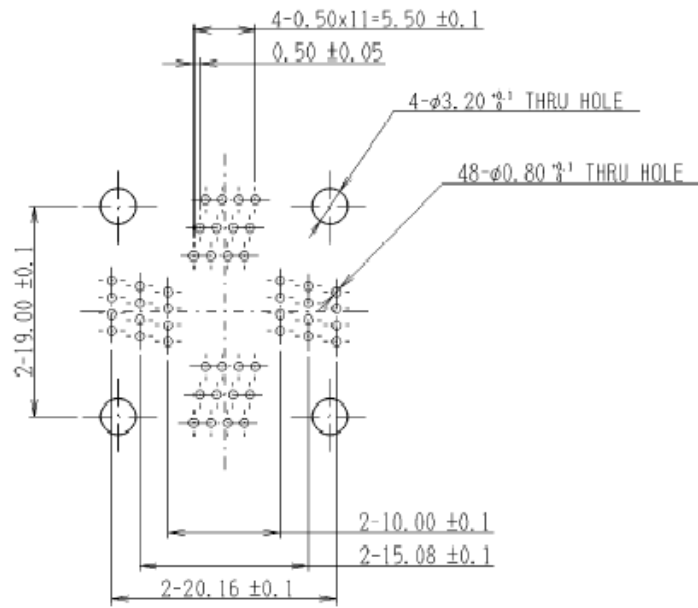

CONTACT & MOUNTING SCREW HOLE PATTERN  
(Pattern shown looking down through top of socket)

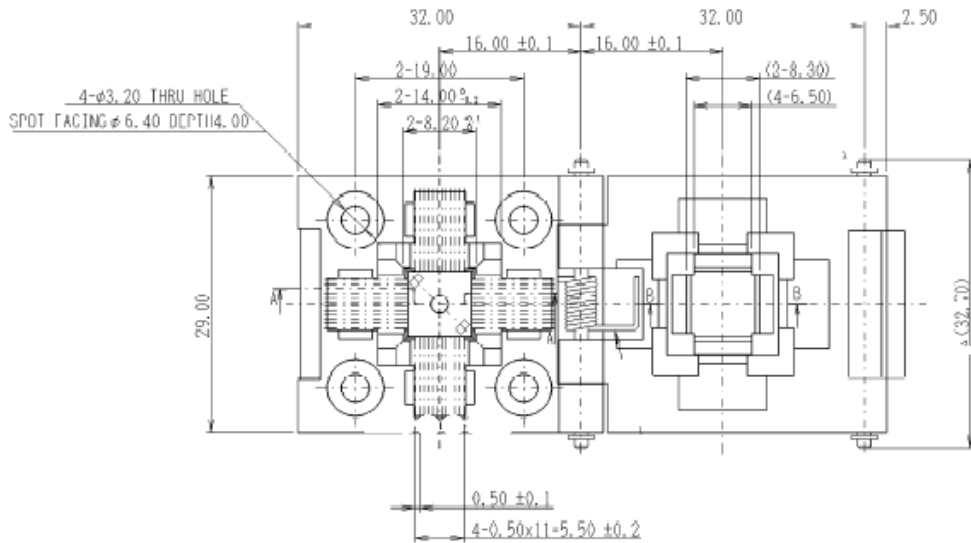
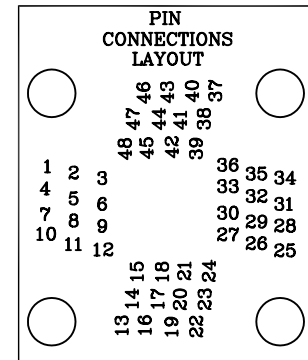
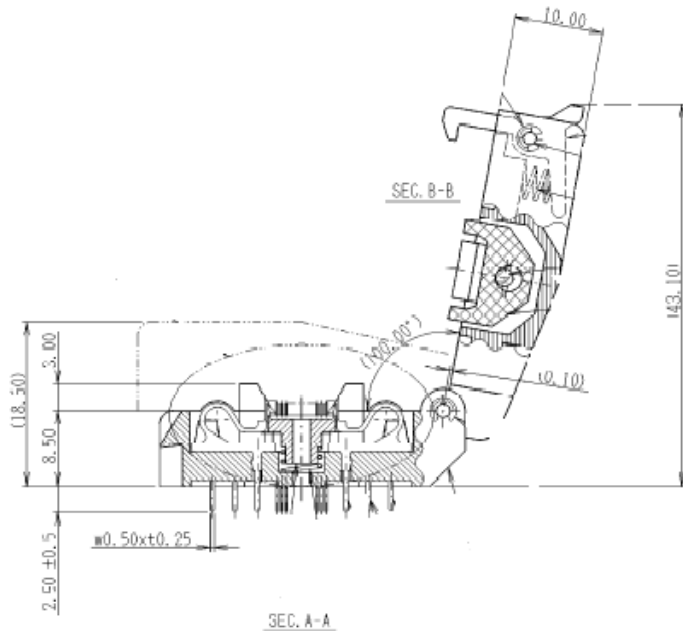

ET-PACKAGE CODE= 48-QF50D

- LEAD COUNT= 48
- BODY SIZE= 7.0mm
- LEAD PITCH= 0.5mm
- TIP TO TIP= 9.0mm

ALL DIMENSIONS ARE IN MILLIMETERS UNLESS OTHERWISE SPECIFIED

**Emulation Technology, Inc.**  
— VLSI and SMT ADAPTERS and ACCESSORIES —

2344 Walsh Avenue, Bldg. F Santa Clara, Ca 95051  
TEL:(408)982-0660 FAX:(408)982-0664

|                       |                          |                      |                             |
|-----------------------|--------------------------|----------------------|-----------------------------|
| SHEET: 1 OF 1         | DATE: 06/20/03           | REVISION: D          | <b>ASSEMBLY DRAWING</b>     |
| CHECKED: Perry Munroe | DRAWN: Miguel Delgadillo | ITEM: S-QFP-00-048-A |                             |
| DO NOT SCALE DRAWING  |                          |                      | DESCRIPTION: S-QFP-00-048-A |