

1.27mm pitch Box Header

THT straight, right angle & - SMT -

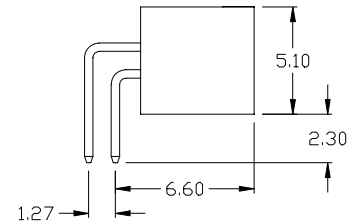
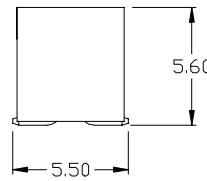
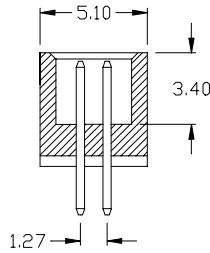
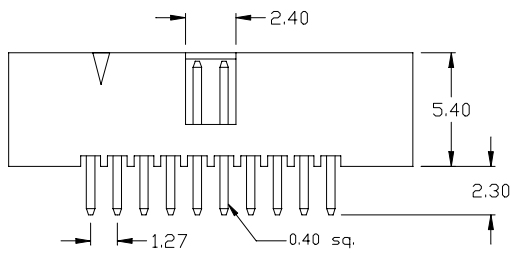
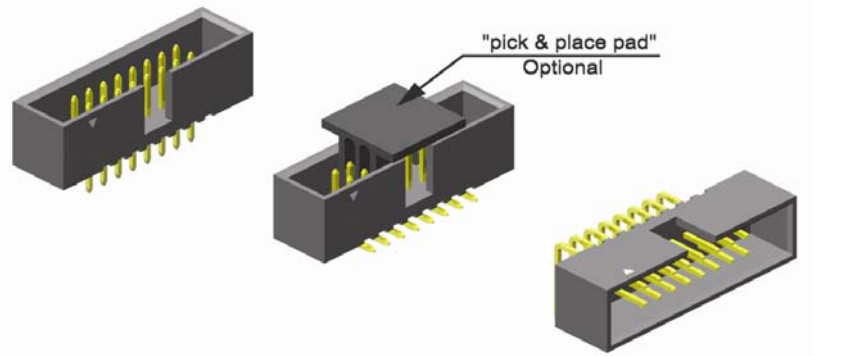
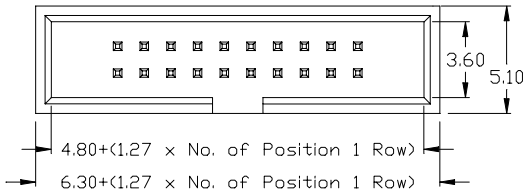

S 510

H 510

R 510

**APPLICATION AND FEATURES**

- **Standard: tube packing**
- Designed to mate with IDC female connector IDS-xxx-W050-55/P page 36
- Reliable flat cable to PCB connection
- No ejection latches for space saving

**P C B Hole and Surface Mount Layout**

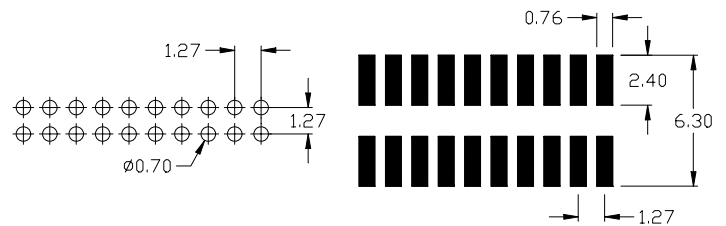

**SPECIFICATIONS**

Current rating	1 A	Operating temperature	- 40°C to +105°C
Insulator resistance	5000 MΩ min.	Processing temperature SMT	+250°C +0/-5°C for 20~40sec.
Contact resistance	20 mΩ max.	Contact material (RoHS compliant)	Copper Alloy
Dielectric withstanding	AC 500 V	Insulator material (RoHS compliant)	LCP UL 94 V-0

**How to order**

**SLS - xxx - X xxx - 55/11 (X)**

